

SUCTION CUPS / Flat

VF150



Features and Strengths

Specifically designed for flat and curved surface
Available to handle multiple objects with the same suction cup

Examples of use

Metal sheet, Veneer sheets, Glass, Electronic components



Recommended Lifting Force (Max.)

Model	Volume (cm ³)	Lifting Force (Kg) - Perpendicular			Lifting Force (Kg) - Parallel		
		- 20 kPa	- 60 kPa	- 90 kPa	- 20 kPa	- 60 kPa	- 90 kPa
VF150	160.00	30.61	86.73	112.24	25.51	61.22	81.63

※ The lifting force above does not include safety factor

Material Specifications

Material	Hardness Shore (°)	Color	Temperature (°C)
NBR	60	Black	-20~110
Silicone	55	Red	-70~200
White Silicone	55	Translucent White	-70~200
White Silicone (FDA)	55	Translucent White	-70~200
High temp. Silicone	50	Blue	-70~280
Conductive Silicone	70	Smoky Black	-45~90
Urethane	60	Dark Green	0~100
Mark Free	75	Black	-10~100

Material Resistance

Description	NBR	Silicone	White Silicone	High temp. Silicone	Conductive Silicone	Urethane	Mark Free
Wear Resistance	Excellent	Good	Good	Good	Good	Excellent	Good
Oil	Excellent	Poor	Poor	Poor	Poor	Excellent	Excellent
Weather / Ozone	Fair	Excellent	Excellent	Excellent	Excellent	Excellent	Excellent
Alcohol	Good	Good	Good	Good	Good	Fair	Good
Acid	Fair	Poor	Poor	Poor	Poor	Poor	Excellent

Dimension

[Unit : mm]

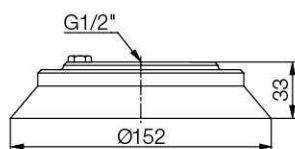

[With 12F fitting]

I Build an Ordering No.

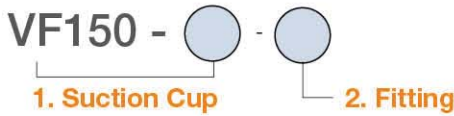

1. Suction cup	Description	Symbol
	Flat suction cup, 150mm diameter, Nitrile (NBR)	VF150-N
	Flat suction cup, 150mm diameter, Silicone	VF150-S
	Flat suction cup, 150mm diameter, White silicone	VF150-WS
	Flat suction cup, 150mm diameter, White silicone (FDA)	VF150-WS (FDA)
	Flat suction cup, 150mm diameter, High temperature silicone	VF150-HS
	Flat suction cup, 150mm diameter, Conductive silicone	VF150-CS
	Flat suction cup, 150mm diameter, Urethane	VF150-U
	Flat suction cup, 150mm diameter, Mark free	VF150-A

2. Fitting	Description	Symbol
	Fitting, G1/2 female	12F
	Fitting, G1/2 female, Mesh filter	M-12F
	Fitting, G1/2 female, Button valve	12F-BV

I Spare Parts – Rubber Parts

Part No.	Description	Weight (g)	Color
VF150-N	Flat suction cup, 150mm diameter, Nitrile (NBR)	351	Black
VF150-S	Flat suction cup, 150mm diameter, Silicone	333.9	Red
VF150-WS	Flat suction cup, 150mm diameter, White silicone	340.96	Translucent White
VF150-WS (FDA)	Flat suction cup, 150mm diameter, White silicone (FDA)	340.96	Translucent White
VF150-HS	Flat suction cup, 150mm diameter, High temperature silicone	362.96	Blue
VF150-CS	Flat suction cup, 150mm diameter, Conductive silicone	347.59	Smoky Black
VF150-U	Flat suction cup, 150mm diameter, Urethane	363.63	Dark Green
VF150-A	Flat suction cup, 150mm diameter, Mark free	375.48	Black

I Dimension

[Unit : mm]

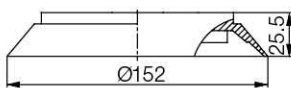

[Rubber Part]

I Spare Parts – Fittings

Part No. (Code No.)	Fitting size	Description	Weight (g)
350 000 3615	12F	G1/2 female	198.93
350 000 4015	12F-F	G1/2 female, Mesh filter	199.73
350 020 3615	12F-BV	G1/2 female, Button valve	314.47