

SUCTION CUPS / Flat

VF50x2



Features and Strengths

Specifically designed for flat and curved surface
Available to handle multiple objects with the same suction cup

Examples of use

Metal sheet, Veneer sheets, Glass, Electronic components



Recommended Lifting Force (Max.)

Model	Volume (cm ³)	Lifting Force (Kg) - Perpendicular			Lifting Force (Kg) - Parallel		
		- 20 kPa	- 60 kPa	- 90 kPa	- 20 kPa	- 60 kPa	- 90 kPa
VF50x2	10.00	3.67	7.55	9.79	2.44	4.08	5.10

※ The lifting force above does not include safety factor

Material Specifications

Material	Hardness Shore (°)	Color	Temperature (°C)
NBR	60	Black	-20~110
Silicone	55	Red	-70~200
White Silicone	55	Translucent White	-70~200
White Silicone (FDA)	55	Translucent White	-70~200
High temp. Silicone	50	Blue	-70~280
Conductive Silicone	70	Smoky Black	-45~90
Urethane	60	Dark Green	0~100
Mark Free	75	Black	-10~100

Material Resistance

Description	NBR	Silicone	White Silicone	High temp. Silicone	Conductive Silicone	Urethane	Mark Free
Wear Resistance	Excellent	Good	Good	Good	Good	Excellent	Good
Oil	Excellent	Poor	Poor	Poor	Poor	Excellent	Excellent
Weather / Ozone	Fair	Excellent	Excellent	Excellent	Excellent	Excellent	Excellent
Alcohol	Good	Good	Good	Good	Good	Fair	Good
Acid	Fair	Poor	Poor	Poor	Poor	Poor	Excellent

Dimension

[Unit : mm]

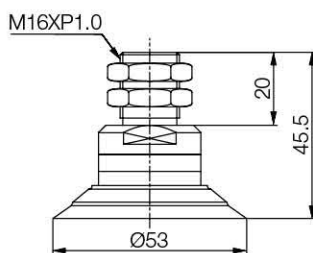

[With M16M fitting]

I Build an Ordering No.

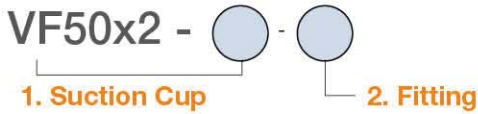

1. Suction cup	Description	Symbol
	Flat suction cup, 50mm diameter, Nitrile (NBR)	VF50x2-N
	Flat suction cup, 50mm diameter, Silicone	VF50x2-S
	Flat suction cup, 50mm diameter, White silicone	VF50x2-WS
	Flat suction cup, 50mm diameter, White silicone (FDA)	VF50x2-WS (FDA)
	Flat suction cup, 50mm diameter, High temperature silicone	VF50x2-HS
	Flat suction cup, 50mm diameter, Conductive silicone	VF50x2-CS
	Flat suction cup, 50mm diameter, Urethane	VF50x2-U
	Flat suction cup, 50mm diameter, Mark free	VF50x2-A
2. Fitting	Description	Symbol
	Fitting, M16 male	M16M

I Spare Parts – Rubber Parts

Part No.	Description	Weight (g)	Color
VF50x2-N	Flat suction cup, 50mm diameter, Nitrile (NBR)	12.25	Black
VF50x2-S	Flat suction cup, 50mm diameter, Silicone	11.88	Red
VF50x2-WS	Flat suction cup, 50mm diameter, White silicone	11.88	Translucent White
VF50x2-WS (FDA)	Flat suction cup, 50mm diameter, White silicone (FDA)	11.88	Translucent White
VF50x2-HS	Flat suction cup, 50mm diameter, High temperature silicone	11.88	Blue
VF50x2-CS	Flat suction cup, 50mm diameter, Conductive silicone	11.98	Smoky Black
VF50x2-U	Flat suction cup, 50mm diameter, Urethane	12.3	Dark Green
VF50x2-A	Flat suction cup, 50mm diameter, Mark free	14.2	Black

I Spare Parts – Fittings

Part No. (Code No.)	Fitting size	Description	Weight (g)
350 000 1405	M16M	M16 male	52.23