

# SUCTION CUPS / Flat

## VF75



### Features and Strengths

Specifically designed for flat and curved surface  
Available to handle multiple objects with the same suction cup

### Examples of use

Metal sheet, Veneer sheets, Glass, Electronic components



### Recommended Lifting Force (Max.)

Model	Volume (cm <sup>3</sup> )	Lifting Force (Kg) - Perpendicular			Lifting Force (Kg) - Parallel		
		- 20 kPa	- 60 kPa	- 90 kPa	- 20 kPa	- 60 kPa	- 90 kPa
VF75	20.00	8.16	20.40	27.55	6.12	11.22	14.28

※ The lifting force above does not include safety factor

### Material Specifications

Material	Hardness Shore (°)	Color	Temperature (°C)
NBR	60	Black	-20~110
Silicone	55	Red	-70~200
White Silicone	55	Translucent White	-70~200
White Silicone (FDA)	55	Translucent White	-70~200
High temp. Silicone	50	Blue	-70~280
Conductive Silicone	70	Smoky Black	-45~90
Urethane	60	Dark Green	0~100
Mark Free	75	Black	-10~100
Polyurethane	60	Translucent Orange	0~60

### Material Resistance

Description	NBR	Silicone	White Silicone	High temp. Silicone	Conductive Silicone	Urethane	Mark Free	Polyurethane
Wear Resistance	Excellent	Good	Good	Good	Good	Excellent	Good	Excellent
Oil	Excellent	Poor	Poor	Poor	Poor	Excellent	Excellent	Excellent
Weather / Ozone	Fair	Excellent	Excellent	Excellent	Excellent	Excellent	Excellent	Excellent
Alcohol	Good	Good	Good	Good	Good	Fair	Good	Fair
Acid	Fair	Poor	Poor	Poor	Poor	Poor	Excellent	Fair

### Dimension

[ Unit : mm ]

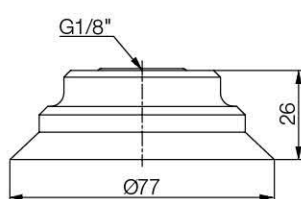

[With 18F fitting]

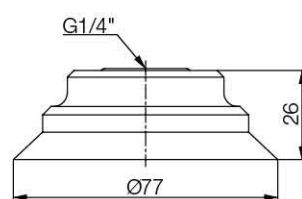

[With 14F fitting]

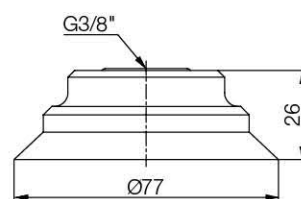

[With 38F fitting]

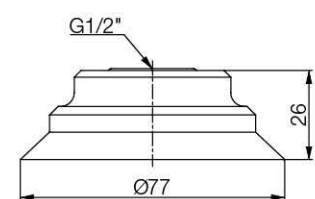

[With 12F fitting]

## Build an Ordering No.

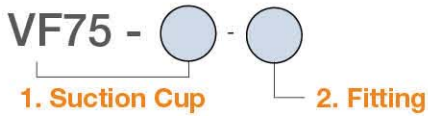

1. Suction cup	Description	Symbol
	Flat suction cup, 75mm diameter, Nitrile (NBR)	VF75-N
	Flat suction cup, 75mm diameter, Silicone	VF75-S
	Flat suction cup, 75mm diameter, White silicone	VF75-WS
	Flat suction cup, 75mm diameter, White silicone (FDA)	VF75-WS (FDA)
	Flat suction cup, 75mm diameter, High temperature silicone	VF75-HS
	Flat suction cup, 75mm diameter, Conductive silicone	VF75-CS
	Flat suction cup, 75mm diameter, Urethane	VF75-U
	Flat suction cup, 75mm diameter, Mark free	VF75-A
	Flat suction cup, 75mm diameter, Polyurethane	VF75-PU

2. Fitting	Description	Symbol
	Fitting, G1/8 female	18F
	Fitting, G1/8 female, Mesh filter	M-18F
	Fitting, G1/8 female, Button valve	18F-BV
	Fitting, G1/4 female	14F
	Fitting, G1/4 female, Mesh filter	M-14F
	Fitting, G3/8 female	38F
	Fitting, G3/8 female, Mesh filter	M-38F
	Fitting, G1/2 female	12F
	Fitting, G1/2 female, Mesh filter	M-12F

## Spare Parts – Rubber Parts

Part No.	Description	Weight (g)	Color
VF75-N	Flat suction cup, 75mm diameter, Nitrile (NBR)	47.72	Black
VF75-S	Flat suction cup, 75mm diameter, Silicone	46.07	Red
VF75-WS	Flat suction cup, 75mm diameter, White silicone	46.07	Translucent White
VF75-WS (FDA)	Flat suction cup, 75mm diameter, White silicone (FDA)	46.07	Translucent White
VF75-HS	Flat suction cup, 75mm diameter, High temperature silicone	46.07	Blue
VF75-CS	Flat suction cup, 75mm diameter, Conductive silicone	46.17	Smoky Black
VF75-U	Flat suction cup, 75mm diameter, Urethane	47.75	Dark Green
VF75-A	Flat suction cup, 75mm diameter, Mark free	53.46	Black
VF75-PU	Flat suction cup, 75mm diameter, Polyurethane	45.72	Translucent Orange

## Dimension

[ Unit : mm ]

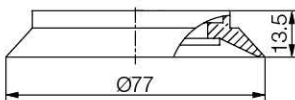

[Rubber Part]

## Spare Parts – Fittings

Part No. (Code No.)	Fitting size	Description	Weight (g)
350 000 3323	18F	G1/8 female	59.36
350 000 4323	18F-F	G1/8 female, Mesh filter	59.76
350 020 3323	18F-BV	G1/8 female, Button valve	83.56
350 000 3423	14F	G1/4 female	56.92
350 000 3823	14F-F	G1/4 female, Mesh filter	57.32
350 000 3523	38F	G3/8 female	55.08
350 000 3923	38F-F	G3/8 female, Mesh filter	55.48
350 000 3623	12F	G1/2 female	51.50
350 000 4023	12F-F	G1/2 female, Mesh filter	51.90