

SUCTION CUPS / Flat & Curve

VFC75x1

Features and Strengths

Specifically designed for flat and curved surface
Available to handle multiple objects with the same suction cup

Examples of use

Automobile Windscreens, Roof and Door, Metal Sheet
Shaped Metal panel, TV cathode ray tube



Recommended Lifting Force (Max.)

Model	Volume (cm ³)	Lifting Force (Kg) - Perpendicular			Lifting Force (Kg) - Parallel		
		- 20 kPa	- 60 kPa	- 90 kPa	- 20 kPa	- 60 kPa	- 90 kPa
VFC75x1	30.00	7.65	19.38	25.51	6.19	15.46	20.90

※ The lifting force above does not include safety factor

Material Specifications

Material	Hardness Shore (°)	Color	Temperature (°C)
NBR	60	Black	-20~110
Silicone	55	Red	-70~200
White Silicone	55	Translucent White	-70~200
White Silicone (FDA)	55	Translucent White	-70~200
High temp. Silicone	50	Blue	-70~280
Conductive Silicone	70	Smoky Black	-45~90
Urethane	60	Dark Green	0~100
Mark Free	75	Black	-10~100
Polyurethane	60	Translucent Orange	0~60

Material Resistance

Description	NBR	Silicone	White Silicone	High temp. Silicone	Conductive Silicone	Urethane	Mark Free	Polyurethane
Wear Resistance	Excellent	Good	Good	Good	Good	Excellent	Good	Excellent
Oil	Excellent	Poor	Poor	Poor	Poor	Excellent	Excellent	Excellent
Weather / Ozone	Fair	Excellent	Excellent	Excellent	Excellent	Excellent	Excellent	Excellent
Alcohol	Good	Good	Good	Good	Good	Fair	Good	Fair
Acid	Fair	Poor	Poor	Poor	Poor	Poor	Excellent	Fair

Dimension

[Unit : mm]

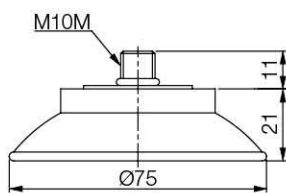

[With M10M fitting]

Build an Ordering No.

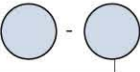
VFC75x1 -  : Pre-mounted fitting

1. Suction Cup

1. Suction cup	Description	Weight(g)	Symbol
	Flat-Curved suction cup, 75mm diameter, Nitrile (NBR), M10xP1.5 Male Fitting	41.39	VFC75x1-N-M10M
	Flat-Curved suction cup, 75mm diameter, Silicone, M10xP1.5 Male Fitting	38.41	VFC75x1-S-M10M
	Flat-Curved suction cup, 75mm diameter, White silicone, M10xP1.5 Male Fitting	40.27	VFC75x1-WS-M10M
	Flat-Curved suction cup, 75mm diameter, White silicone (FDA), M10xP1.5 Male Fitting	40.27	VFC75x1-WS-M10M (FDA)
	Flat-Curved suction cup, 75mm diameter, High temperature silicone, M10xP1.5 Male Fitting	43.79	VFC75x1-HS-M10M
	Flat-Curved suction cup, 75mm diameter, Conductive silicone , M10xP1.5 Male Fitting	40.99	VFC75x1-CS-M10M
	Flat-Curved suction cup, 75mm diameter, Urethane, M10xP1.5 Male Fitting	41.24	VFC75x1-U-M10M
	Flat-Curved suction cup, 75mm diameter, Mark free, M10xP1.5 Male Fitting	47.13	VFC75x1-A-M10M
	Flat-Curved suction cup, 75mm diameter, Polyurethane, M10xP1.5 Male Fitting	38.22	VFC75x1-PU-M10M